

Bordeaux's Chateaux, Rivers & Wine



TRIP OVERVIEW

Characterised by sprawling vineyards surrounding opulent châteaux, charming cities spliced by winding cobbled lanes, scenic beauty that flanks the Dordogne and of course, world-renowned wines — our seven day cruise affords you the opportunity to undertake fantastic optional trips, that include an exhilarating helicopter ride over Médoc and a tempting wine tasting experience.

ITINERARY & DETAILS

This document aims to give you all the information that you require for a smooth and comfortable trip on this river cruise. Please take the time to read this dossier to familiarise yourself with all the aspects of our river cruise. It includes important information such as flight details, visa requirements and travel insurance.

Your included meal guide:

B = Breakfast, **L** = Lunch, **D** = Dinner.

Day 1: UK to Bordeaux D

Depart London on your scheduled flight to Bordeaux. Upon arrival, you will be met and transferred to your ship, MS Cyrano de Bergerac. Board your ship and enjoy a welcome cocktail with the crew before dinner. The cruise will set sail to Pauillac. You will board your ship at 6pm.

Day 2: Pauillac to Royan B/L/D

Today you will dock at Pauillac, and begin a tour of the prestigious wine-growing region of Medoc. Favoured by a mild, humid microclimate, this region produces some of the world's most sought-after red wines. The trail will take you along the famous Chateaux Route, past rolling valleys, verdant fields and the wine estates and elegant castles of Saint Julien, Margaux, Lafite-Rothschild and Latour. With stops along the route, sample the region's exquisite wines and discover why they are revered by connoisseurs across the globe. Cruise the Gironde until you reach the estuary. Dock in Royan and enjoy a panoramic tour of the seaside city.

Day 3: Royan B/L/D

Enjoy the day at leisure in Royan or alternatively join an optional excursion to the seaside cities of Rochefort and La Rochelle. Visit the Corderie Royale, a historical rope-making factory. Built between 1666 and 1669, it was the first industrial building in France, and the factory provided ropes for the French Navy and its ships for over three centuries. Tour the main building and learn about the techniques used to produce the ropes used on the large sailing ships. Afterwards, head to La Rochelle. Stop for lunch in a local restaurant. The over 1,000-year-old city of La Rochelle is the capital of the Charente Maritime. It's tucked along the Bay of Biscay and contains some of the most beautiful natural and architectural heritage in the area. During a guided tour of the old town and port, learn about the Grosse-Horloge gate, Renaissance arcades, lovely half-timbered homes, finely sculpted facades of the private mansions, and the cathedral. Enjoy some free time before returning to the ship. At the end of our afternoon, begin cruising to Libourne. Enjoy dinner and an evening of entertainment.

Day 4: Libourne to Bordeaux B/L/D

This morning enjoy a guided tour of Saint-Émilion's underground monuments, discovers the rich history of this medieval city, including its enigmatic monolithic church. Continue to a vineyard where you will learn how the famous local wine is produced. Enjoy a tasting of local products at the end of the tour. Return to the ship in Libourne and spend the afternoon cruising to Bordeaux.

Day 5: Bordeaux to Cadillac B/L/D

Cruise along the Garonne, getting a good glimpse of Bordeaux from the water as the ship continues to Cadillac. This morning visit the magnificent and prestigious Château de Roquetaillade. This castle has been the backdrop for several French films including Brotherhood of the Wolf (Le Pacte des Loups) and Fanfan la Tulipe. Explore the towers of this this medieval château before heading to a wine cellar in the Sauternais to enjoy a tasting of the famous Sauternes wine. Afterwards return to Cadillac for a guided tour of the city. Located on the right bank of the Garonne River, the city was founded in 1280 and still retains its original structure. Explore the port, its ramparts, and the main square and stroll the streets to admire the old homes and 15th-century church. Spend the afternoon cruising to Bordeaux and enjoy the gala evening.

Day 6: Bordeaux B/L/D

After breakfast on board depart to the center of Arcachon Bay. We will start our tour with a boat trip on the Bassin d'Arcachon. You'll be able to see the Bird Island, the famous "Cabanes tchanquées" houses on stilts and the oyster beds. Then, we will visit of the Oyster Centre and Museum located in Larros Port in Gujan Mestras. A modern, interactive scenography will help you discover oyster farming and the history of the oyster. We will have lunch in a local restaurant. In the afternoon, we will go to the Great Dune of Pilat. Culminating at 107m, it is the highest sand dune in Europe. The view from the top is awe-inspiring. Return to Bordeaux at the end of the day.

Day 7: Bordeaux to UK or extension B

Disembark the ship at 9am where you will transfer to the airport for your return flight back to the UK or continue on to your chosen extension.

Meals

Breakfast, lunch and dinner daily are taken onboard the ship. Tables seat 4 and 6 people, so you'll be able to converse and socialise with new friends, whilst never feeling crowded together. Tea and coffee are available on board ship as well as unlimited soft drinks and alcoholic drinks, including a variety of wines and beer, both during meals and at the bar. (Premium brands are available at an extra cost). Any dietary requirements and dislikes should be made known to our reservations staff at the time of booking. On embarking the ship, you will be greeted by the captain, crew and staff and treated to welcome cocktails.

SHIP INFORMATION

Ship information - 5★ Cyrano de Bergerac

The 5★ MS Cyrano de Bergerac is a modern ship with 87 invitingly decorated cabins, accentuated by a number of vibrant paintings. You can enjoy a drink from the bar whilst relaxing on the vessel's terrace, soak up rays on the sun deck or simply take in the views from the comfort of your cabin.

Length: 110m long
Cabins 87 cabins

Width 11.40m wide
Passengers: 174 passengers

Facilities

- Lounge bar with a dance floor ■ Bar with TV and terrace ■ Restaurant
- Large sundeck ■ Terrace ■ French balconies ■ Heating/air-conditioning



MS Cyrano de Bergerac

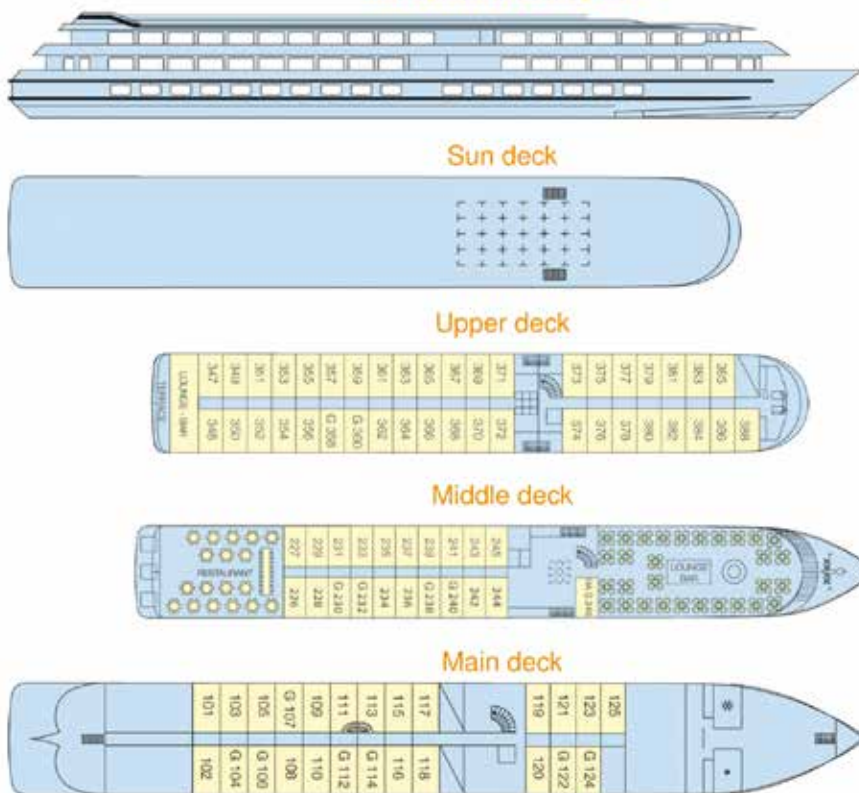

The Cabins

All cabins are equipped with shower and toilet, hairdryer, satellite TV, radio and safe.
Upper deck: 41 cabins (39 cabins with twin beds, 2 cabins with a double bed(G))
Middle deck: 21 cabins (16 cabins with twin beds, 4 cabins with a double bed (G) (can be separated into 2 singles), 1 disabled cabin with a double bed (HA G)
Main deck: 25 cabins with porthole (18 cabins with twin beds, 7 cabins with a double bed(G))

Final confirmation of your deck and cabin will be confirmed at booking. Please contact us if you have any queries.

Twin Cabin

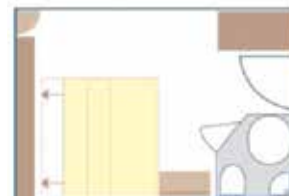

Double Cabin

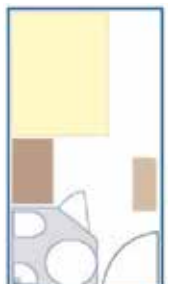

WEATHER AND CLIMATE

Weather can vary quite considerably throughout the year, so please familiarise yourself with the climate charts below.

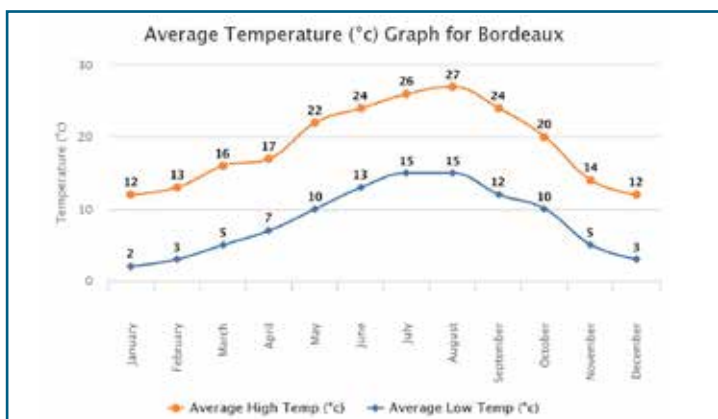

WHAT YOU NEED FOR YOUR TOUR

Visas

A visa is not required for British nationals travelling to France. Further advice should be sought from the applicable tourist authority for other nationalities and for general queries. We strongly advise you check your destinations' Tourist Board or Embassy for the most up-to-date guidelines regarding passport validity.

Tour Guides

An English-speaking Cruise Director will be on board your cruise to help with any queries that you may have. While on excursions included in your itinerary, you will be accompanied by an English-speaking local tour guide. When exploring locally during your leisure time you will not be accompanied by a tour guide.

Please note: Your cruise is shared with international clients from other companies.

Shared cruise

Please note: your cruise is shared with international clients from other companies.

Tipping

Tipping is at your discretion. There is an envelope in your cabin for these purpose that can be handed to reception at the end of your cruise.

Currency Exchange

The currency in France as well as on board is the Euro (€). We recommend that you exchange your currency before you leave the UK. It is important that you budget carefully and ensure you have the right form of currency before you arrive in the country. Cash machines will also be available throughout the tour in order to withdraw money in your local currency.

Personal Expenses

This cruise is All-Inclusive, so you will only need to take a little extra money with you to cover any premium drinks on board and souvenirs, drinks and snacks purchased when off the ship, as well as any optional excursions you wish to book.

Credit Card Information

Credit cards are accepted on board ship and throughout France.

Electricity Supply

The electricity supply is 220V. You will need a European two pin round plug adapter in France.

DRESS CODE & WHAT TO PACK

Dress Code

There is no official dress code on board, however you'll be most comfortable during the day in smart casual clothing. You may wish to bring items that do not wrinkle easily as there is no iron provided on board ship. There are also no laundry facilities available. Bring a variety of clothing for the weather expected on your cruise, including light clothing and bathing suits for hot weather, a jumper or jacket for cooler weather and of course a raincoat and/or small umbrella.

Itinerary Changes

The Captain and Croisieurope reserve the right to alter/modify an itinerary at any time, should safety or external circumstances make this necessary, changes are also subject to tides. Some of the highlights may only be seen on optional excursions at an additional cost, or by exploring independently.

Health and Vaccinations

It is your responsibility to check any health and vaccination requirements applicable to your booked arrangements. We can only provide general information about this. Health and hygiene facilities and disease risks vary from country to country. You should take health advice about your own needs as early as possible and in good time before your departure. Sources of information include; www.fco.gov.uk, www.travelhealthpro.org.uk, www.hpa.org.uk, your General Practitioner or a specialist clinic.

Physical Accessibility

This river cruise is accessible to most people with an average level of fitness and normal mobility. It involves moderate days of walking on cobble streets and getting on and off the cruise ship. This cruise is not suitable for anyone with walking difficulties.

Insurance

We strongly recommend that you and all members of your party are suitably insured as soon as you book your holiday. It is a condition of booking that you must have suitable travel insurance. It is important that you purchase travel insurance that suitably covers your participation in whatever activities you may undertake at the time that you make your booking. To assist you with this, we have arranged travel insurance in partnership with Holiday Extras. To arrange your travel insurance with Holiday Extras, please call **0800 781 4237** and quote **'WK830'** for preferential rates. Please ensure you provide us with the name of your insurer, policy number and their 24 hour emergency contact number as soon as possible. Mercury Holidays will not be liable for any costs incurred by you due to your failure to take out suitable travel insurance from the date of booking.

Ship Information

If the ships detailed are not available, alternatives will be used of a similar standard.

What to Pack

- Comfortable walking shoes such as trainers for sightseeing excursions
- Sun cream and a hat with a big brim for sunny days
- Sunglasses
- Ruck sack or light bag per person
- Personal toiletries
- Insect repellent
- Personal first aid kit containing travel pills, rehydration powder, plasters, stomach settlers, antiseptic creams, aspirin etc.

FLIGHT INFORMATION

IMPORTANT: Please note that final flight details, including terminal, airline and baggage allowance, will be confirmed on your final documentation which will be sent to you approximately 10 days before departure. A printed E-ticket is no longer required at check-in, all you need to do is present your passport to the staff at the desk and your boarding pass will be given to you.

Airport Extras

If you wish to arrange Airport car parking or accommodation at preferential rates, we recommend you book this in advance with Holiday Extras on 0871 360 2000, quoting HX313.

Please note

You will receive excursion vouchers with your ticket package.

ON YOUR ARRIVAL

On your arrival in Bordeaux you will be met by a representative from our local agent, CroisiEurope, holding a sign displaying: "Mercury Holidays". The Mercury Holidays/CroisiEurope representative will show you to your transfer vehicle. If you need to contact your representative during your stay the details will be given on your arrival.

EMBARKING & DISEMBARKING

Embarkation Time: 6pm
Disembarkation Time: 9am

Please note that to meet your return flight from this cruise you will have to disembark before the official disembarkation time. Your return transfer will meet you at **7am** and will take you to Bordeaux airport with plenty of time before your flight.

If your arrival is before this time, you will be transferred to the docking area where you will be able to leave your luggage. You are then free to explore the city at your own pace until it is time to board your ship.

BOARDING DETAILS

Please see below for details of your boarding quay. Your cruise company is **CroisiEurope**.

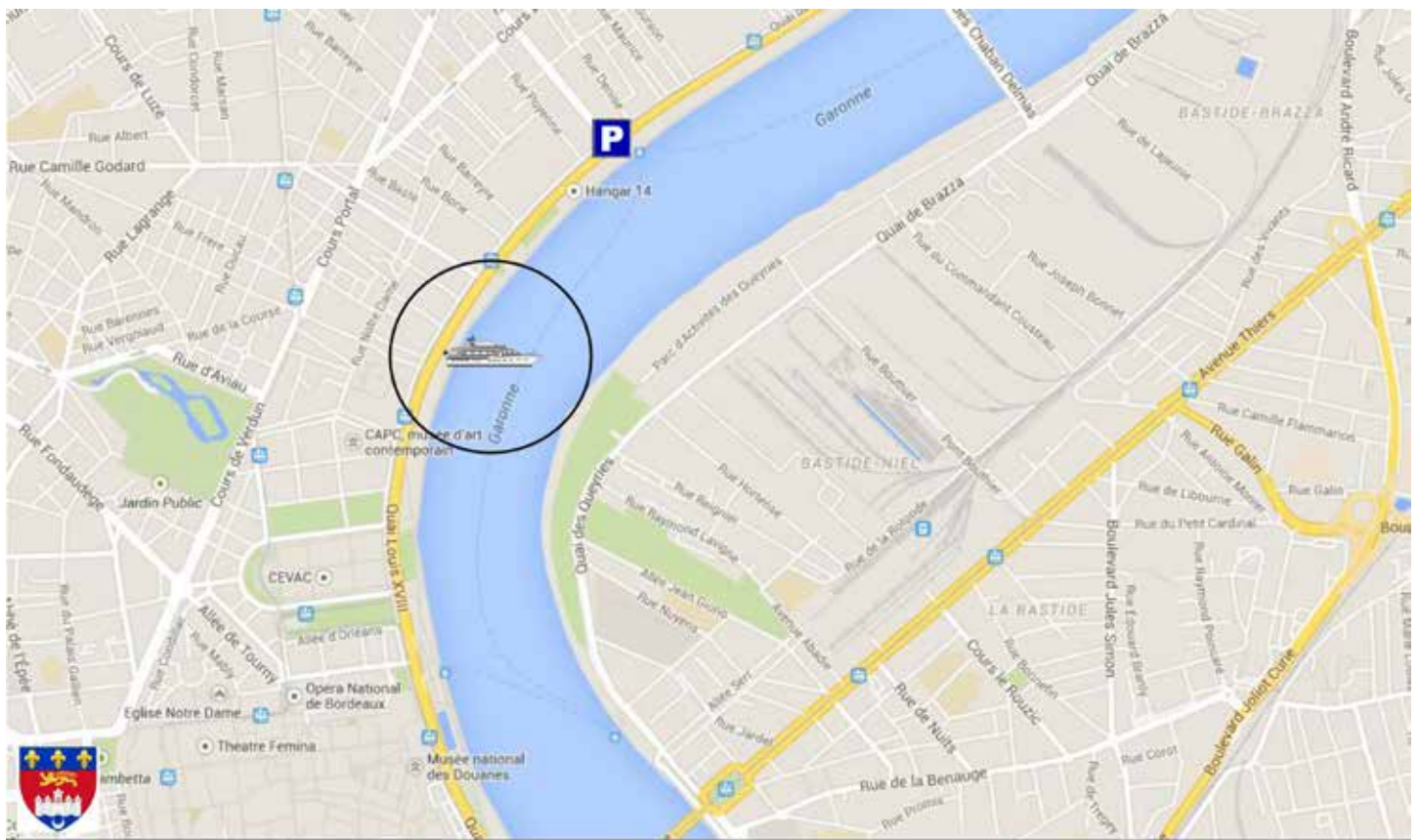

Boarding quay: Quai des Chartrons, on the former site of the Colbert cruiser.

In the unlikely event that your cruise does not operate, then you may be asked to change to a different date. A full refund will be made available, should the alternative dates offered be unsuitable.

Bordeaux City Stay Extension

If you have not yet booked this fabulous extension, there is still time to do so. Please contact 0333 003 0522



TRIP OVERVIEW

Enjoy an extended 2-night stay in stunning Bordeaux, the hub of the famed wine-growing region. Explore this city at your own pace and further discover everything this beautiful area has to offer.

ITINERARY & DETAILS

This document aims to give you all the information which you will require during your beach extension to Bordeaux.

Hotel (2 nights)

Your stay in Bordeaux will take place at the **4★ Hôtel Mercure Bordeaux Château Chartrons** on a Bed and Breakfast basis.

This hotel is ideally placed for exploring the castles and vineyards of Bordeaux. The archetypal village of St Emilion is only 40 minutes away and the sea is less than an hour's drive. Bordeaux and its landscape are a delight you won't soon forget. The strategic downtown location of the hotel means you're just 5 minutes by tram from the Cité du Vin and the Bassins de Lumières. Comfortable rooms have a cozy atmosphere and equipped with a safe, flat screen TV and free Wi-Fi.

Hotel Information

4★ Hôtel Mercure Bordeaux Château Chartrons

Address: 81 Cr Saint-Louis, 33300 Bordeaux, France
Tel: 0033 5 56 43 15 00

Tour Guides

Your stay in Bordeaux is not escorted by a tour guide and your time will be free to explore the area at your own pace. Transfers are included.

Transfers

Arrival transfer: 09:00am, transfer from Cyrano de Bergerac to Hôtel Mercure Bordeaux Château Chartrons.

Return transfer: Pick up at 07:00am at Hôtel Mercure Bordeaux Château Chartrons to Bordeaux airport when booked on BOD-LGW, BA 2787 10:05/10:35.

Supplier: Happy Tours, contact number 0044 07765862730.

Meals

Your stay will be on a Bed and Breakfast basis.

Personal Expenses

You will need to take money with you to cover any meals not included, as well as personal purchases, such as souvenirs, snacks and drinks.



FLIGHT INFORMATION

Please note: Final hotel and flight details will be confirmed on your e-ticket and final documentation which will be sent to you approximately 10 days before departure.

For any further enquiries or for more information call us on **0333 003 0522**